



Henry Echeverria

Educator, Designer, & Technical Director
Portfolio

Selected Past Works

HUMBOLDT STATE UNIVERSITY-Technical Director
Jagun Fly



Production photos

Erecting motel sign



Shaman rigging



Shaman flying

[illegible]

Production photos

Humboldt State University-Props Designer & Construction

City of Angels

Phone booth construction



Paint samples



Completed phone booth



Kingsmen Shakespeare-Production Manager & Technical Director

Macbeth & All's Well That Ends Well

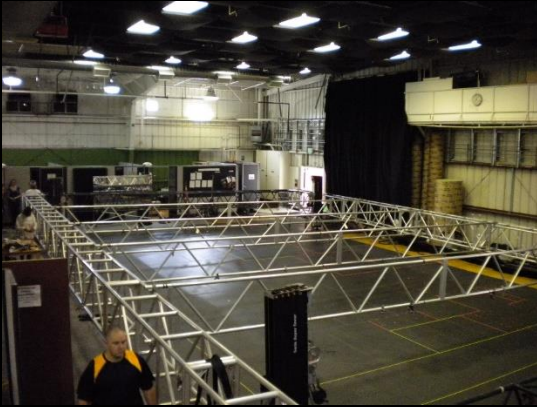

Taking down truss indoors



Truss erection



Stage build



Moving truss to campus park



Stage decked

Designer's perspective drawing

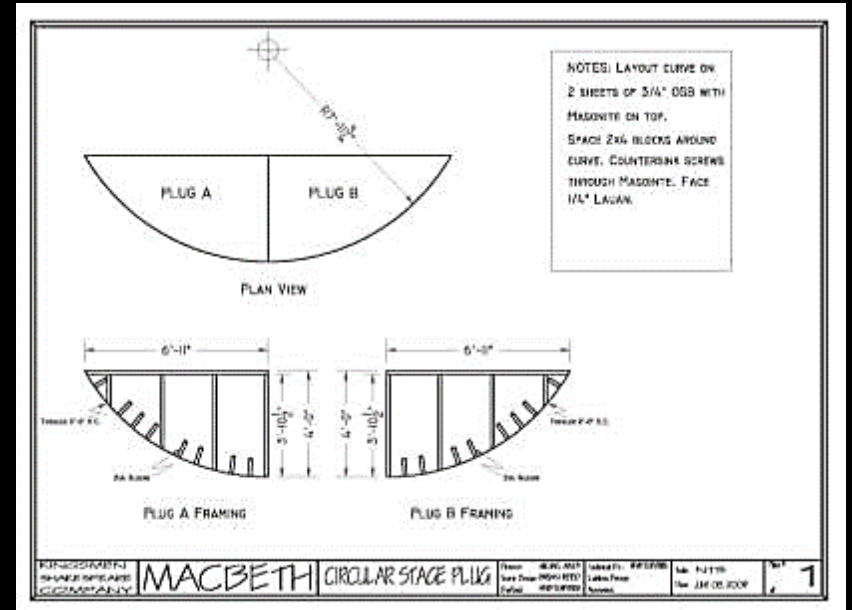
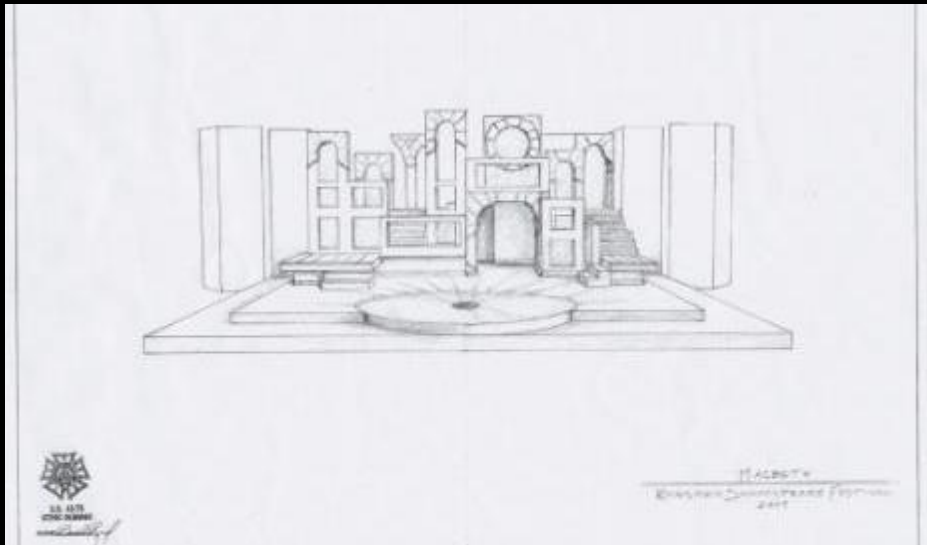

Half-circle drawing



Stage with masonite deck and half-circle plug



Wall G elevation

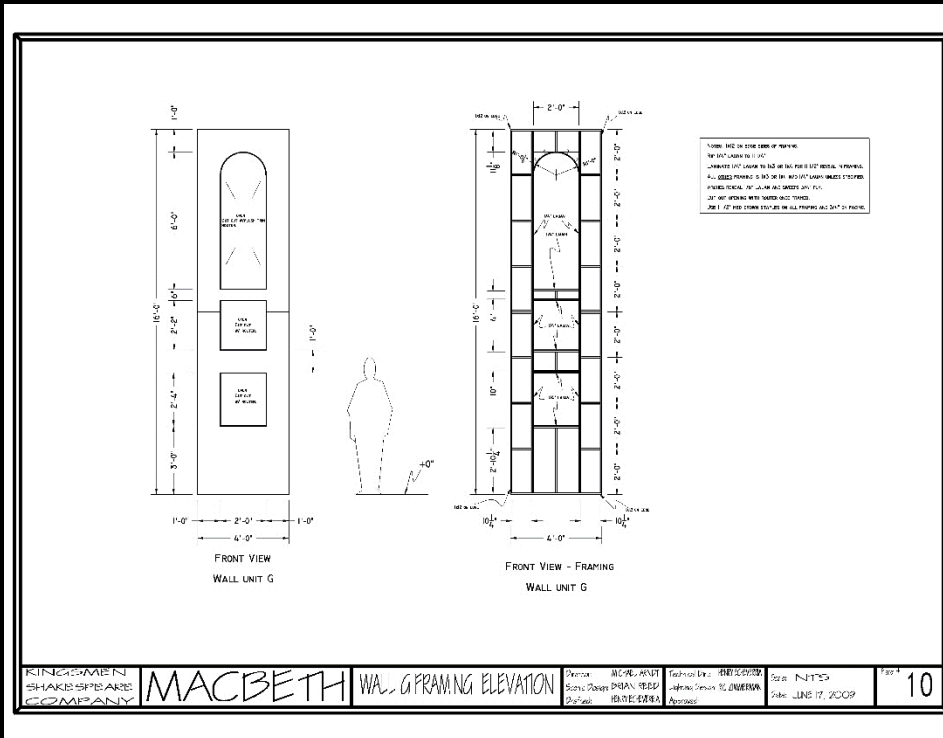

Framing in progress



Skeleton of set



Modified platform



Running cable & circuiting



Assembling shutters



Rose window cut out



Production photos



Production photos



Season budget

AEA proposal form



Information for Equity Proposal and Production(s) Budget Form

Theatre Name: A Noise Within

Season Title: 2011-2012 Inaugural Season

Theatre Location: Glendale, CA 815: 3352 E. Foothill Blvd 91107

Theatre Address: 234 S. Brand Blvd

General 8/15: Pasadena

CA 91204

Administrative Office Phone #:

Back Stage Phone #: 818-265-7962

| Show Title | 1 st Rehearsal | 1 st Equity Rehearsal | 1 st Public Performance | Closing Date | # of Equity Contracts (Actor + ASM) | # Non-Equity Performers | # of weeks on contract | # of Acres in Total Cast |
|-----------------------|---------------------------|----------------------------------|------------------------------------|--------------|--|-------------------------|------------------------|--------------------------|
| Twelfth Night | 9/29/2011 | 9/28/2011 | 10/22/2011 | 12/16/2011 | 9+1 | 4 | | 13 |
| Desire Under the Elms | 10/18/2011 | 10/18/2011 | 11/12/2011 | 12/18/2011 | 5+1 | 1 | | 6 |
| Notches Off (Remount) | 1/3/2012 | 1/3/2012 | 1/26/2012 | 1/15/2012 | 7+1 | 2 | | 9 |
| Anthony and Cleopatra | 1/24/2012 | 1/24/2012 | 2/23/2012 | 3/3/2012 | 110+4 | 1 | | 14 |
| The Bluesman | 2/14/2012 | 2/14/2012 | 3/19/2012 | 3/19/2012 | 7+1 | 1 | | 8 |
| The Bangles | 2/28/2012 | 2/28/2012 | 3/11/2012 | 3/23/2012 | 7+1 | 2 | | 9 |
| | | | | | * | | | |
| | | | | | * | | | |
| | | | | | * | | | |

Proposed Actor Salaries: Stage Manager: \$0.00 Assistant Stage Manager: \$0.00 Actor: \$0.00

Assistant Stage Manager: \$9.00

Author: SEEHRI

Theatre Seating Capacity: 251. Please list the *Ticket Prices* for the Theatre's last or previous season and the proposed season below:

| Simple Tickets | | Subscription Tickets | |
|-----------------|---|----------------------|-----------------|
| Previous Season | Proposed Season | Previous Season | Proposed Season |
| LOW \$16.00 | LOW \$16.00*sliding scale for schools, same tier as low as \$5.00 | LOW \$84.00 | LOW \$84.00 |
| HIGH \$44.00 | HIGH \$44.00 | HIGH \$320.00 | HIGH \$320.00 |

Name of Guarantor (the person who guarantees the bond): Terry Kay

Address: _____ Business: _____

e-mail: kyrylova.13@gmail.com

Home: [446-A Foothill Blvd La Brea, CA 90009](http://446-A-Foothill Blvd La Brea, CA 90009)

Phone: 818-740-9194

Free: 1-800-770-9100

Pharmacokinetic: Highly protein bound

Employer Organization: A Noise Within

Logitech ID #: 0

Unemployment #: 18

Workers' Compensation Carrier: Transfers

Workers' Comp. Carrier Policy #: 0

Name of Producer: A Noise Within/Goeff Elliott/Julia Rodriguez Elliott

Address: Business: 234 S Brand Blvd Glendale, Ca 91204

Phone: 818-265-7957

e-mail: art@cs.hmc.edu

Fax: 818-240-0826

11-12 Season Expenses

Expenses Front Page

| Twelfth Night | | |
|---------------------------|----------------|-------------|
| Department | Total Budgeted | Total Spent |
| Specials | \$5,000.00 | \$4,500.00 |
| Produce | \$800.00 | \$750.00 |
| Concessions | \$1,000.00 | \$1,000.00 |
| Lighting | \$800.00 | \$750.00 |
| Stage and Makeup | \$400.00 | \$350.00 |
| Caters and Servers | \$300.00 | \$250.00 |
| Twelfth Night total spent | | \$10,200.00 |
| Twelfth Night budget | | \$11,300.00 |
| Difference | | \$1,100.00 |

| Item Totals | Budgeted | Spent | Difference |
|-------------|------------|------------|------------|
| Income | \$4,848.00 | \$7,267.24 | \$2,419.24 |
| Property | \$2,000.00 | \$2,200.00 | \$200.00 |
| Phone | \$2,000.00 | \$2,200.00 | \$200.00 |
| Commuter | \$5,500.00 | \$5,340.00 | \$160.00 |
| Lighting | \$600.00 | \$500.00 | \$100.00 |
| Wage | \$1,000.00 | \$881.30 | \$118.70 |
| Interest | \$650.00 | \$440.00 | \$210.00 |
| Insurance | \$2,400.00 | \$1,000.00 | \$1,400.00 |
| Master Card | \$2,000.00 | \$1,200.00 | \$800.00 |
| Car | \$6,000.00 | \$2,000.00 | \$4,000.00 |
| Gas | \$2,000.00 | \$1,000.00 | \$1,000.00 |
| Oil | \$2,000.00 | \$1,000.00 | \$1,000.00 |
| Tire | \$2,000.00 | \$1,000.00 | \$1,000.00 |
| Wash & Wax | \$2,000.00 | \$1,000.00 | \$1,000.00 |
| Car Wash | \$2,000.00 | \$1,000.00 | \$1,000.00 |

| Department | Total Budgeted | Total Spent |
|--------------------|----------------|-------------|
| Security | \$3,500.00 | \$0.00 |
| Police | \$900.00 | \$0.00 |
| Consumers | \$2,300.00 | \$0.00 |
| Lighting | \$300.00 | \$0.00 |
| Signs and Markings | \$400.00 | \$0.00 |
| Charts and Screens | \$300.00 | \$0.00 |
| Grand Total Spent | | \$0.00 |
| Grand Budget | | \$0.00 |
| Difference | | \$0.00 |

| | Actual | Budget | Variance |
|--------------|------------|------------|----------|
| Printing | \$5,000.00 | \$4,737.40 | \$262.60 |
| Replacements | \$225.00 | \$61.87 | \$163.13 |

| Office Supplies | Actual | Budget | Difference |
|-------------------|------------|----------|------------|
| Bus Office | \$1,000.00 | \$80.80 | \$1,080.80 |
| Bus Office Paper | \$1,125.00 | \$758.51 | \$366.49 |
| Bus City Office | \$1,700.00 | \$624.47 | \$1,075.53 |
| Fuels | \$800.00 | \$81.80 | \$718.20 |
| Gas | \$800.00 | \$87.90 | \$712.10 |
| Computer Expenses | \$800.00 | \$374.50 | \$425.50 |

| Department | Total Budgeted | Total Spent |
|---------------------------------|----------------|-------------|
| Security | \$1,000.00 | \$0.00 |
| Phone | \$400.00 | \$0.00 |
| Construction | \$2,500.00 | \$0.00 |
| Lighting | \$300.00 | \$0.00 |
| Water and Sewerage | \$350.00 | \$0.00 |
| Grasses and Shrubs | \$300.00 | \$0.00 |
| Master Off - Total spent | | \$0.00 |
| Master Off Budget | | \$0.00 |
| Difference | | \$0.00 |

AEA weekly payroll report

[illegible]

Twelfth Night



16' functioning shutters

Decking thrust



Photos of set

Fabrication shop projects



Knights with armature



Cherry plywood art exhibit



Paint jar case



Lube guns



Railroad cart



Fabricated multiple pieces for Nintendo kiosk



Angular prototype



Angular exhibit completed



Copper exhibit in progress



Copper exhibit completed



Sandal table



Vasquez rocks museum exhibit in progress



Vasquez rocks museum exhibit

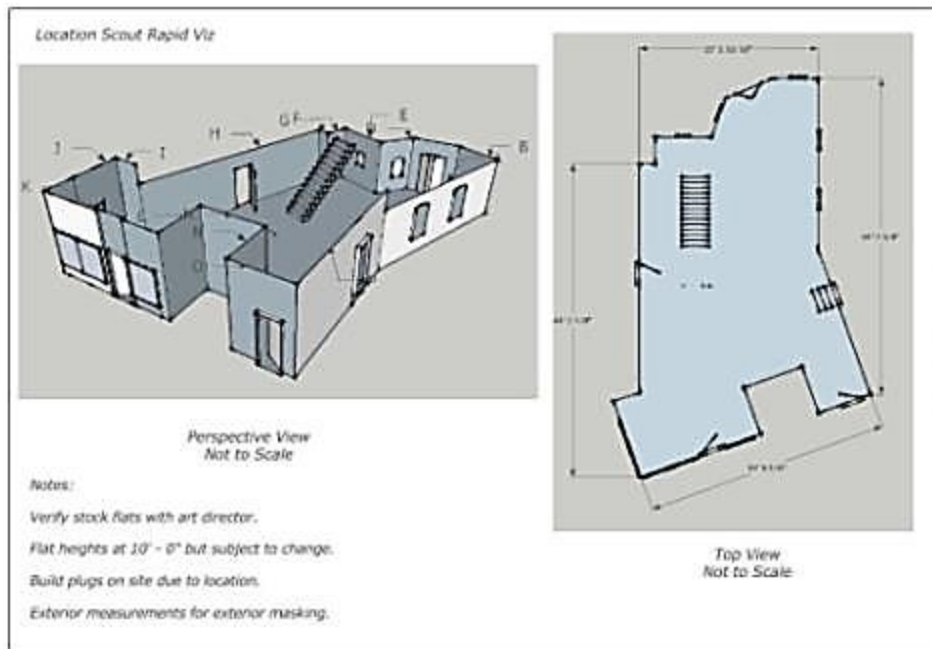

Rapid visualization of scouted location



Welding seaweed base



Welded armatures



Completed seaweed



Welding giant prop oil can



Welding completed



Oil can with decal



Completed oil can



Handle cut and sanded



Handle mounted



Handle holder welded



Fiberglass handle in progress



One version of completed gas pumps



Gas pumps installed at Disney's Cars Land

Averett University-Scenic Designer & Technical Director
The Complete Works of William Shakespeare (Abridged)

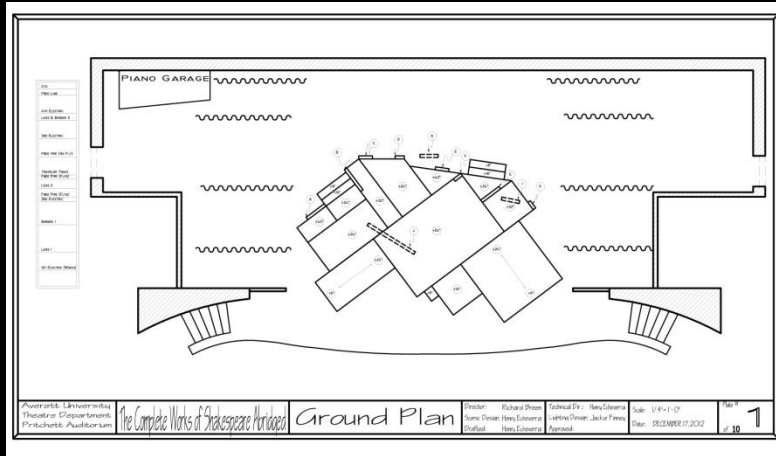

Ground plan

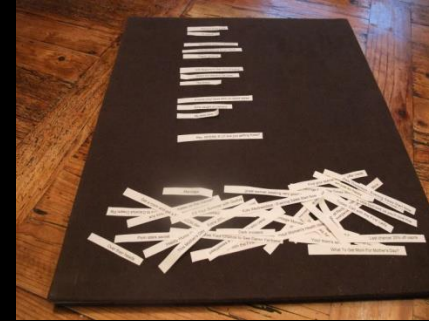

Research

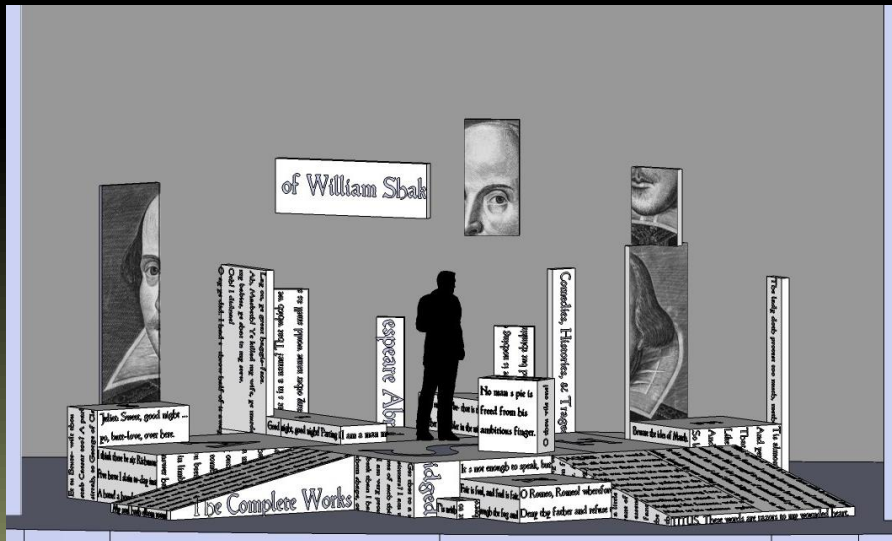

3D model rendering

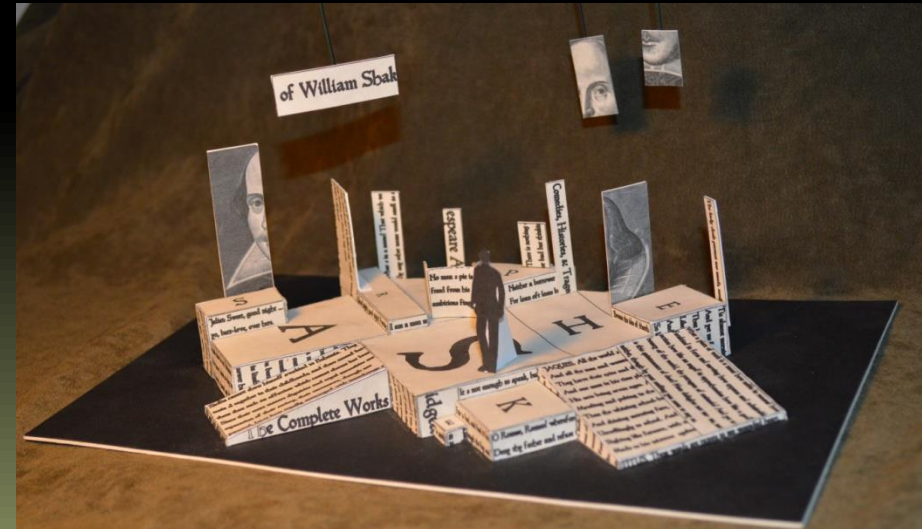

Model



Production photos

Averett University-Scenic Designer & Technical Director *Chicago*

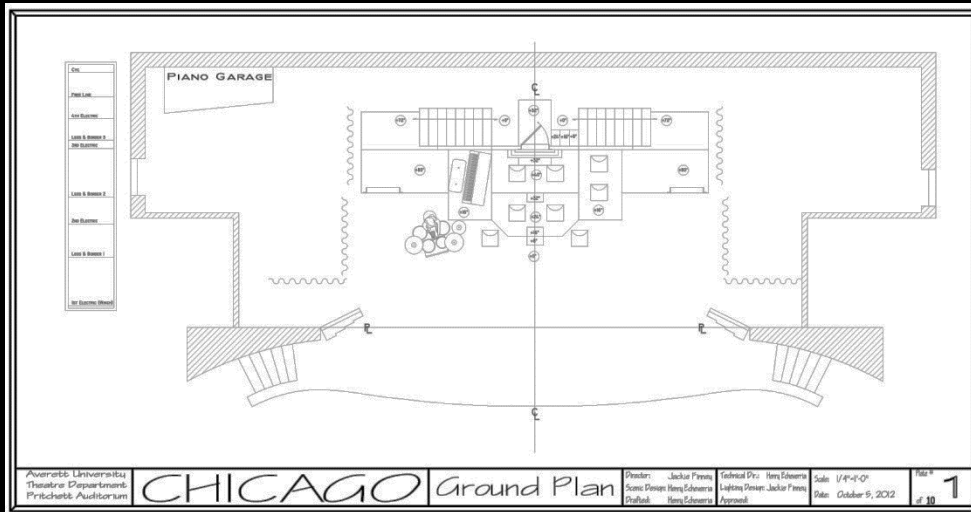

Ground plan



Research



3D model rendering



Production photos

Averett University-Scenic Designer, Projections Designer, & Technical Director
I Never Saw Another Butterfly

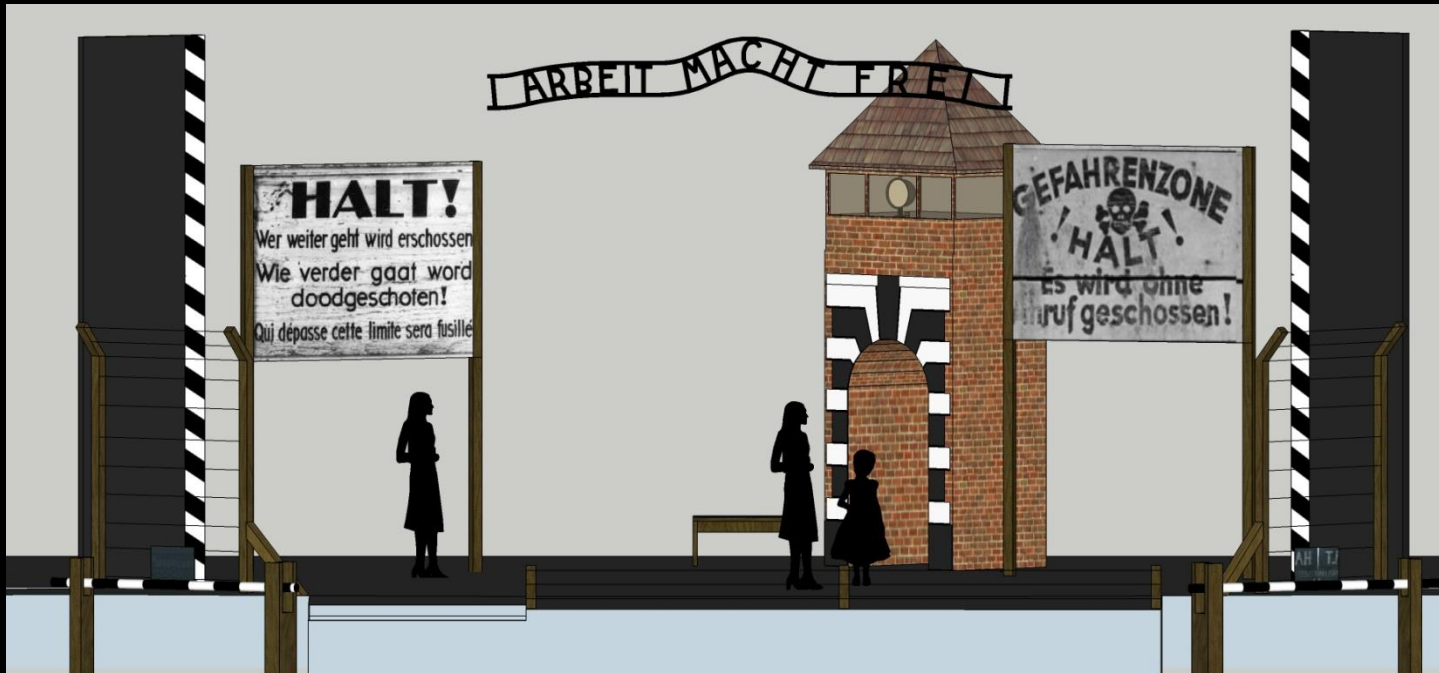

3D model rendering



Production photo



Production photos

Averett University-Scenic Designer & Technical Director
Noises Off

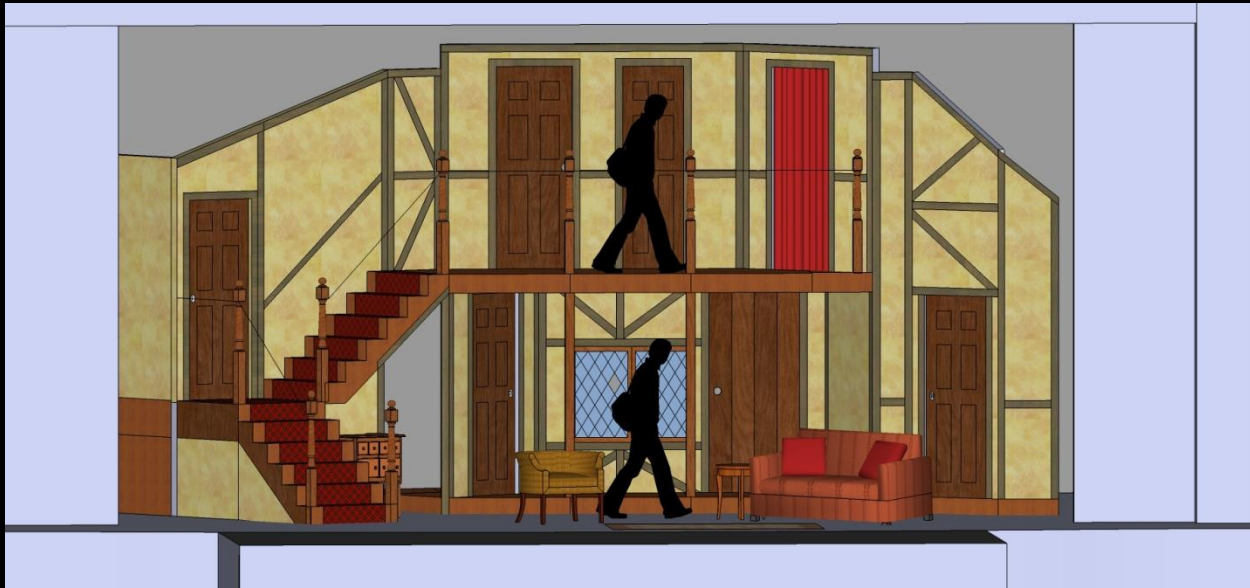

3D model rendering



Production photo



Production photos

Averett University-Scenic Designer & Technical Director
Little Shop of Horrors

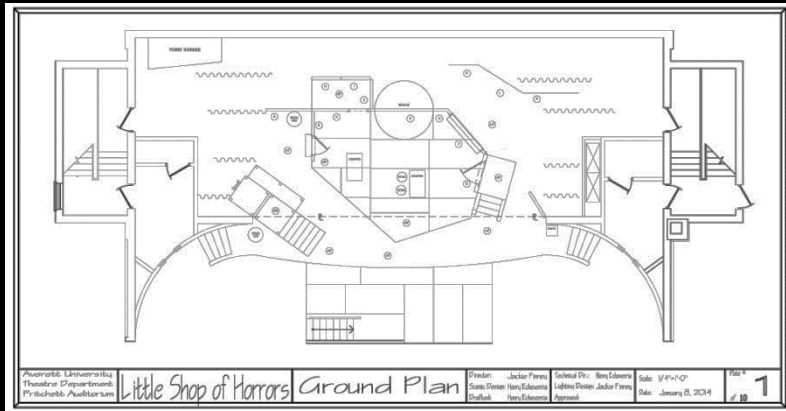

Ground plan

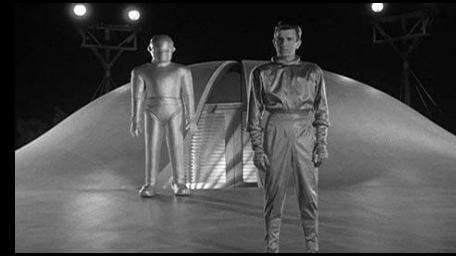

Research



3D model rendering



Production photos

Averett University-Scenic Designer & Technical Director
Sweet Charity



3D model rendering



Production photos



Averett University-Scenic Designer & Technical Director
You're A Good Man Charlie Brown

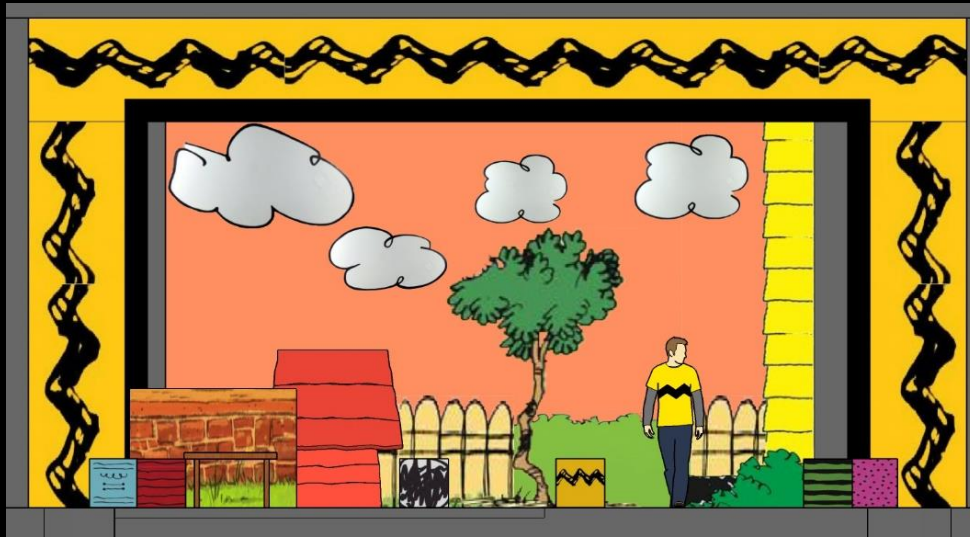

3D model rendering



Production photos



CARTOON WITH PROJECTOR ONTO LAUAN. JIGSAW TOP SECTION. FRAME BOTTOM RAIL, STILES, AND CONNECT SEAMS WITH TOGGLES. SCREW TO DECK. USE JACKS IF NEEDED.

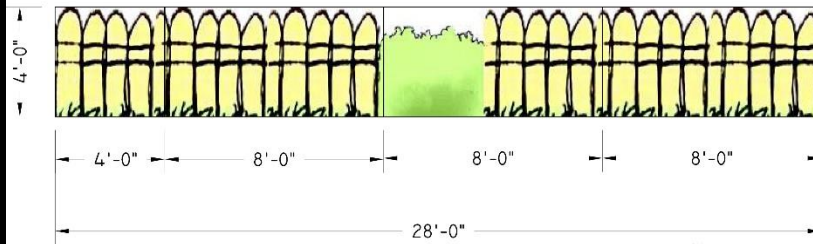

GROUND ROW FENCE FRONT ELEVATION

Scale: NOT TO SCALE

Plate #
2
of 10

CARTOON WITH PROJECTOR ONTO LAUAN. JIGSAW. ATTACH (2) 1X3 ON FACE FOR RIGGING POINTS. ADD RIGGING HARDWARE AND HANG. SEE GROUND PLAN FOR BATTENS.

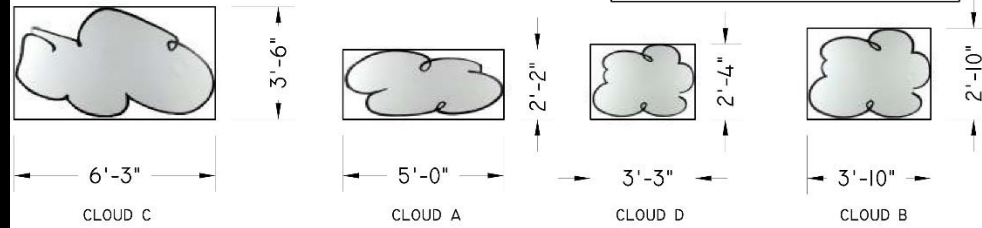

CLOUD A-D FRONT ELEVATIONS

Scale: NOT TO SCALE

Plate #
3
of 10

CARTOON WITH PROJECTOR ONTO 1/2" PLYWOOD FOR LOWER PART OF TREE. CUT EXTRA STRIPS FOR TOP AND SIDES. JIGSAW. SCAB SEAMS TOGETHER WITH 1X3, AS WELL AS WEAK POINTS (THIN TREE TRUNK). ADD RIGGING HARDWARE TO AVAILABLE 1X3 AND HANG. SEE GROUND PLAN FOR BATTENS.

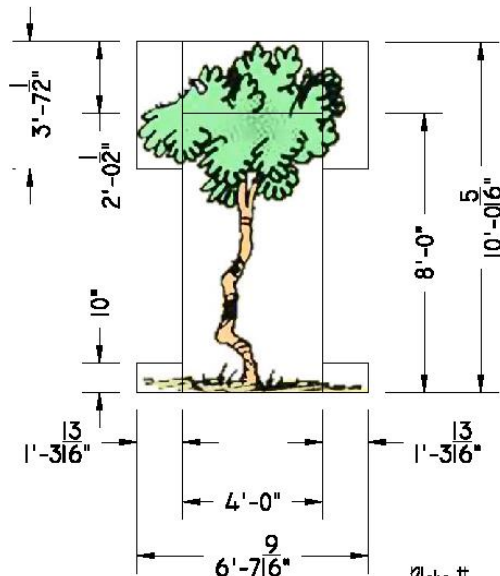

TREE FRONT ELEVATION

Scale: NOT TO SCALE

Plate #
4
of 10

CARTOON WITH PROJECTOR ONTO LAUAN. JIGSAW. FRAME IN 'L' SHAPE. ADD RIGGING HARDWARE TO AVAILABLE 1X3 AND HANG. SEE GROUND PLAN FOR BATTENS. MAY HAVE TO BE ATTACHED TO GROUND ROW FOR ADDITIONAL SUPPORT.

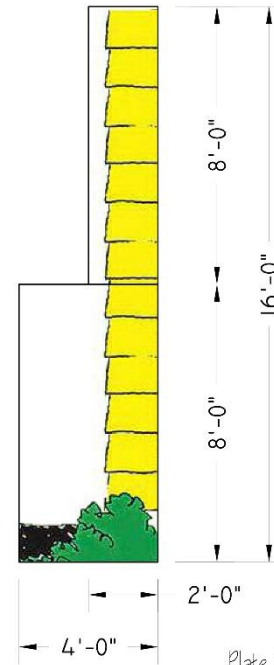

HOUSE SIDING FRONT ELEVATION

Scale: NOT TO SCALE

Plate #
5
of 10

Construction drawings

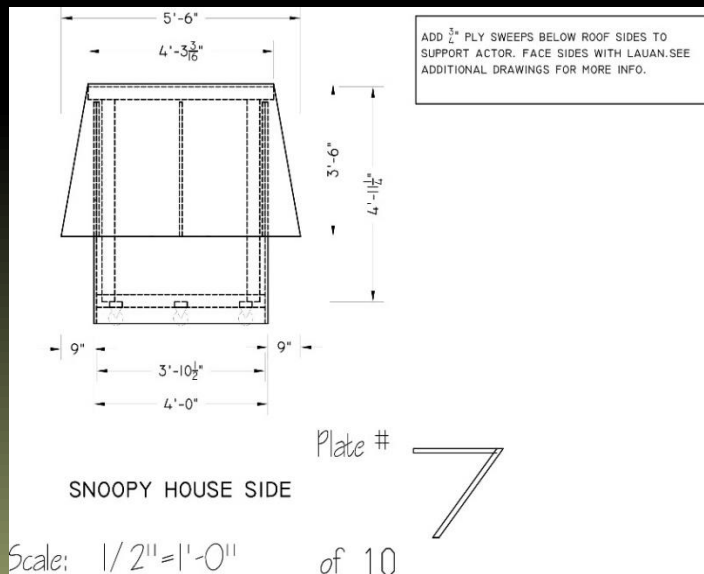
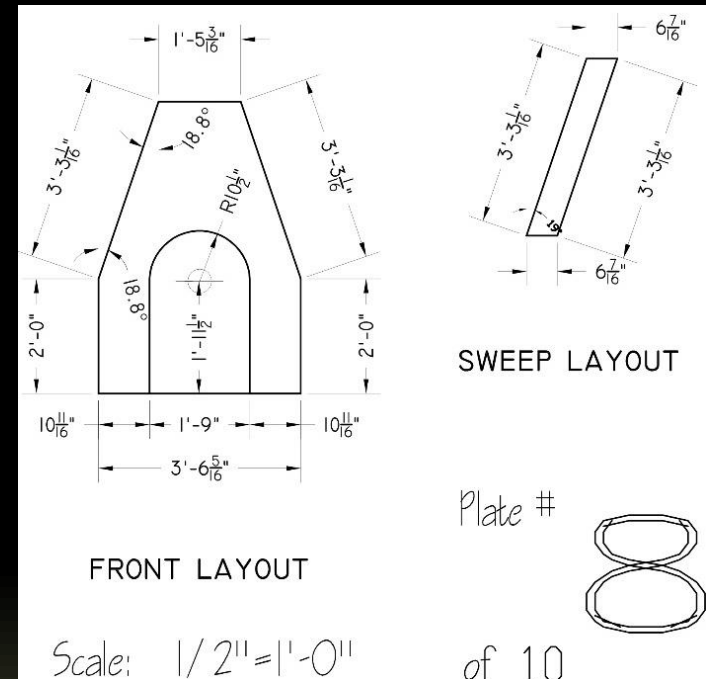
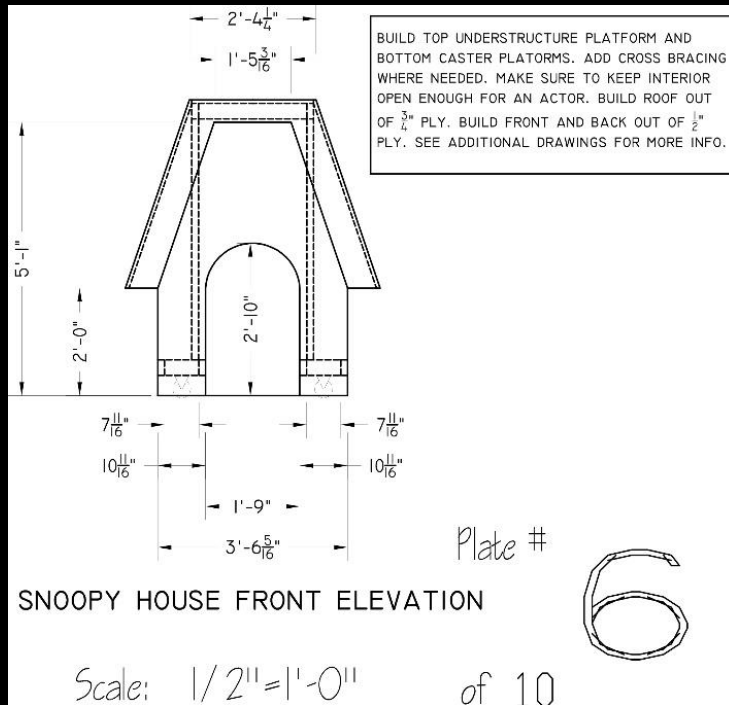

Construction drawings

Averett University-Scenic Designer & Technical Director
To Gillian on Her 37th Birthday



3D model rendering



Production photos

Georgia College & State University-Technical Director
Stick Fly





Georgia College & State University-Technical Director
American Idiot



Production photos



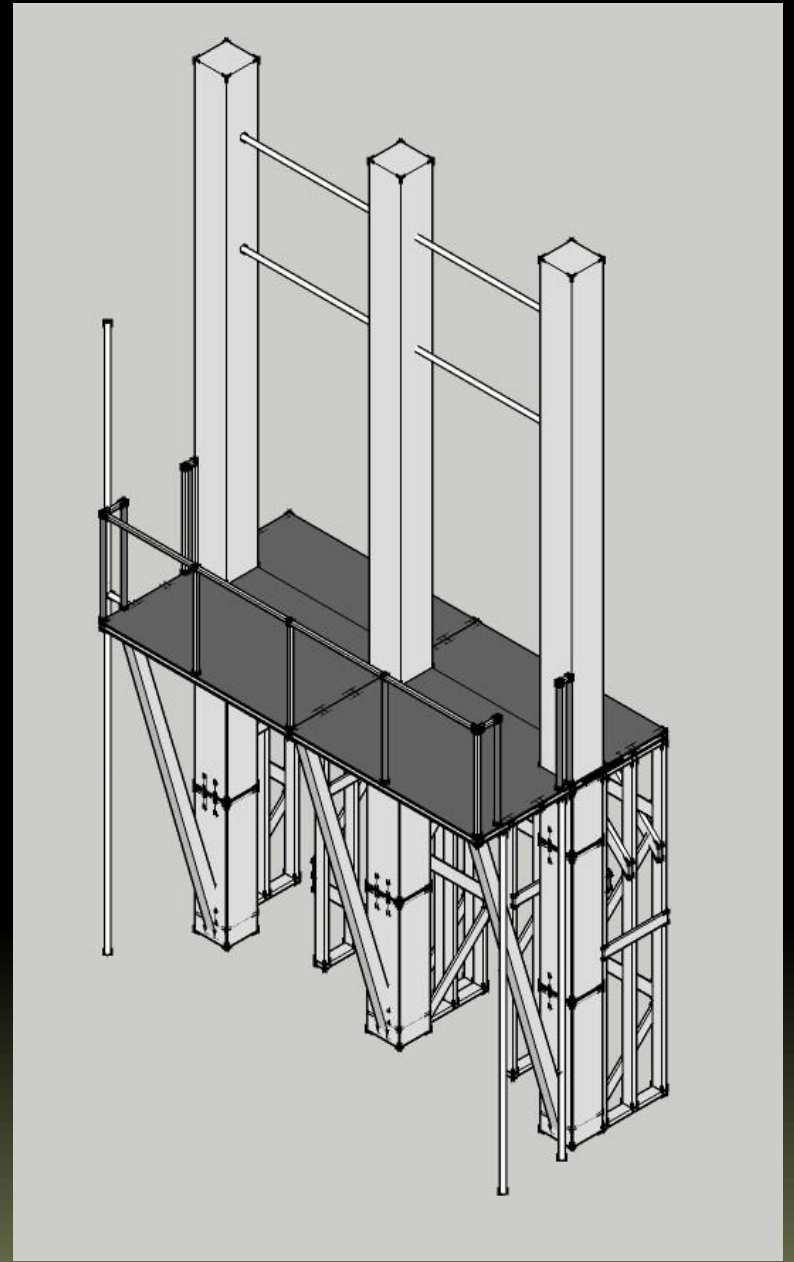
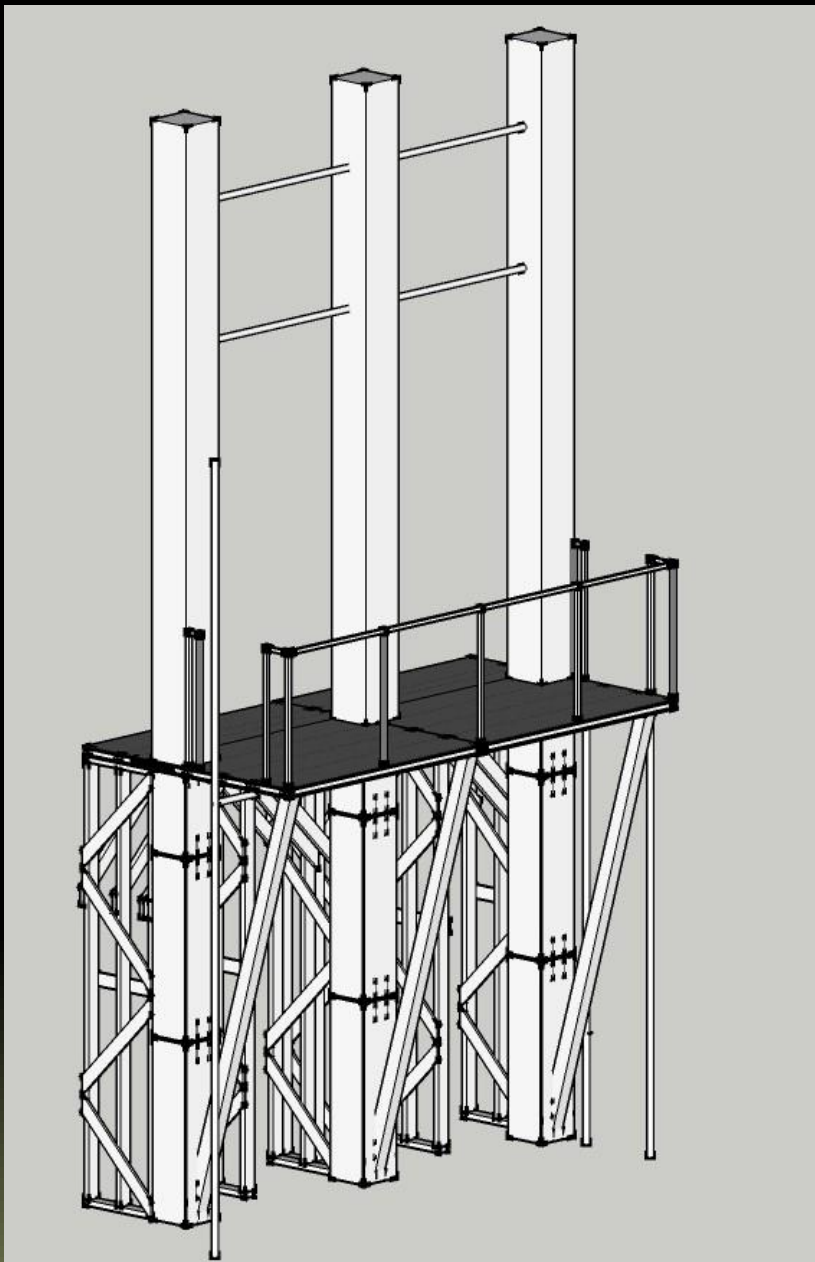

3D model of stressed skin platforms



California State University of Bakersfield-Scenic Designer & Technical Director
Unsorted

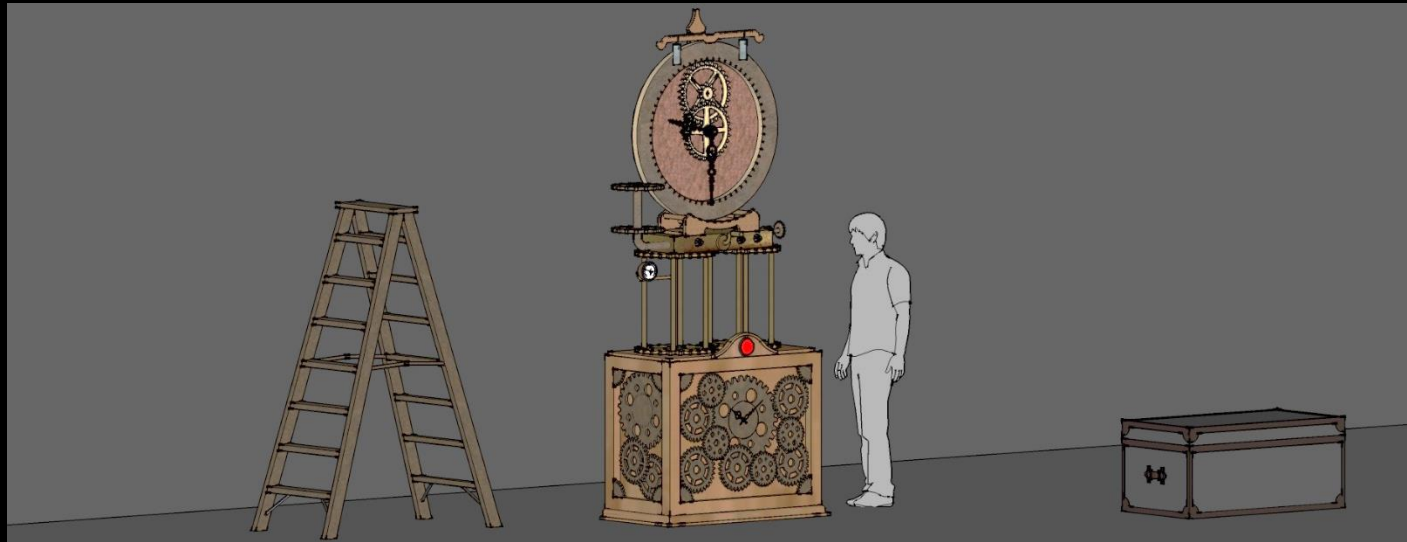

3D model rendering

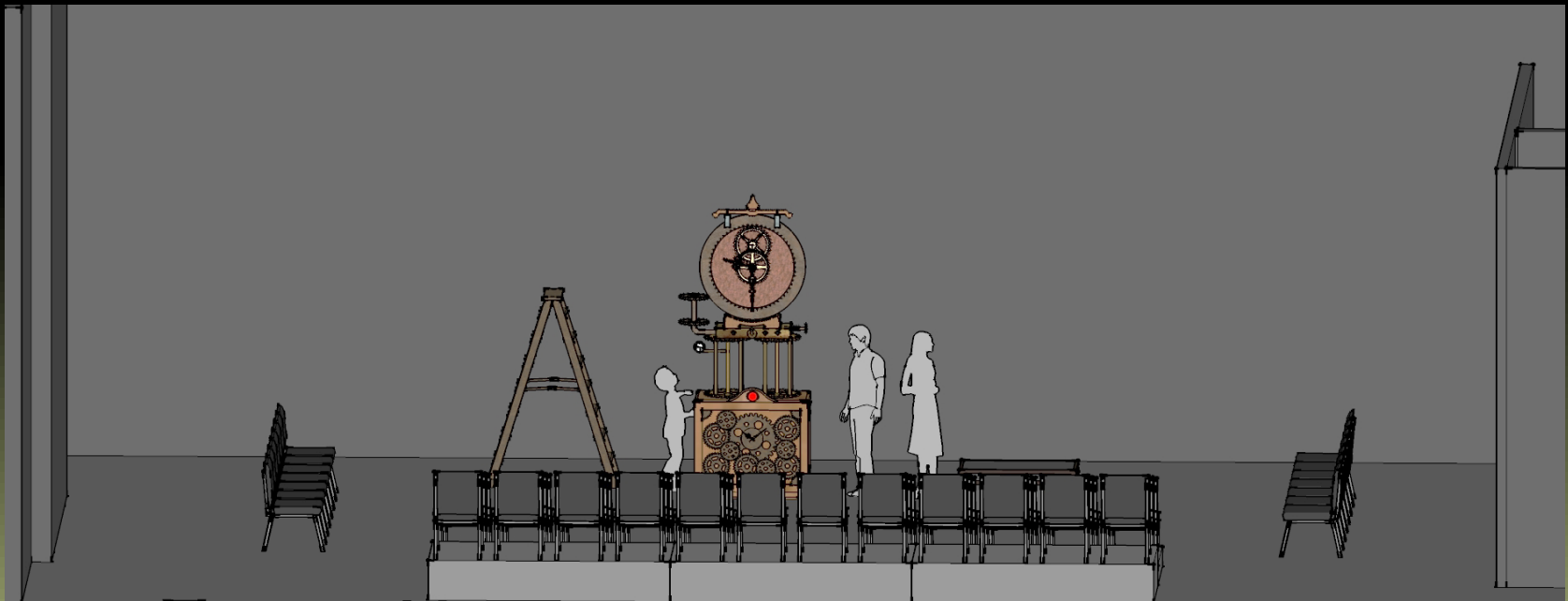

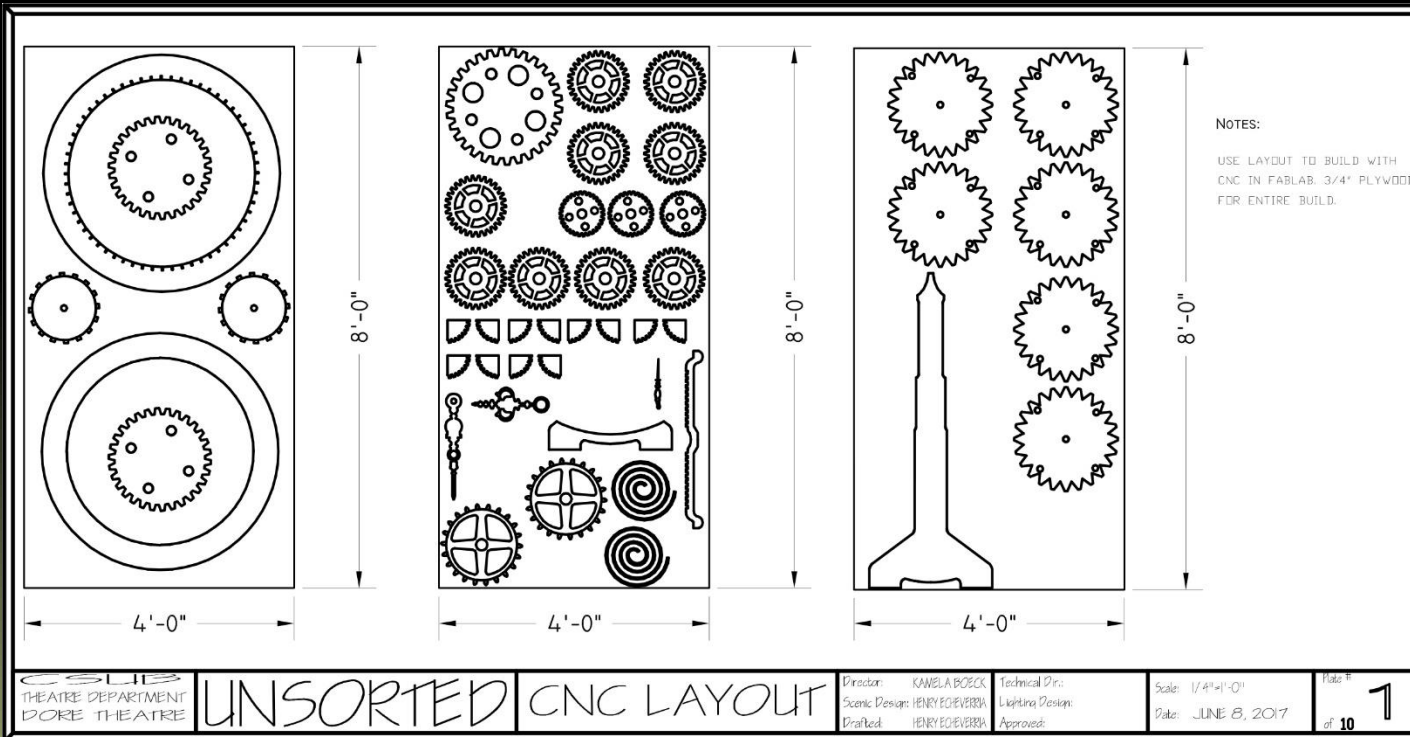
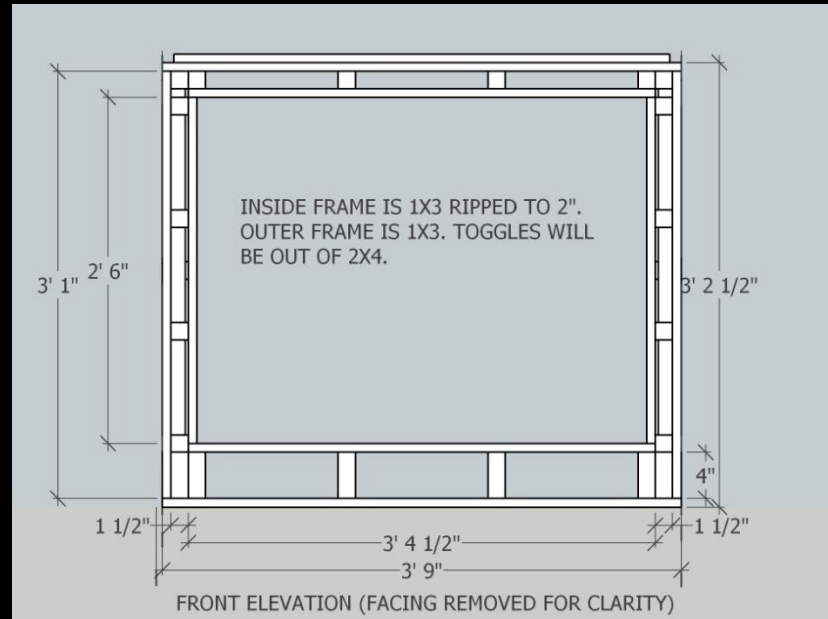
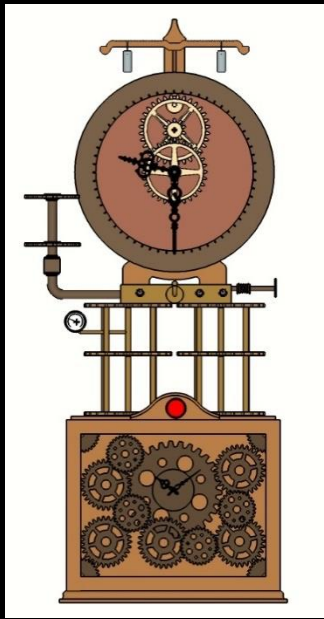

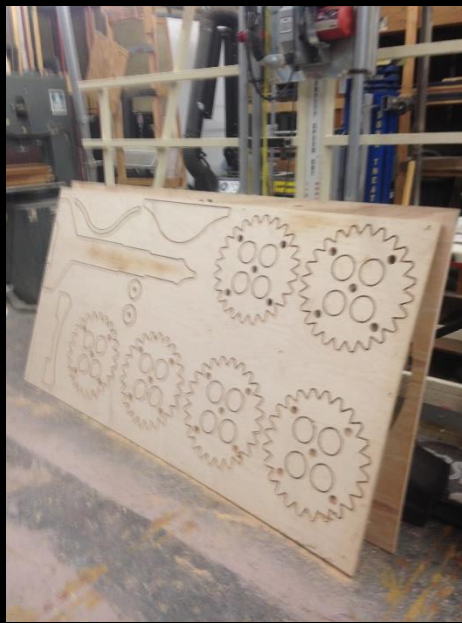

Scenic pieces in CNC

Scenery in progress

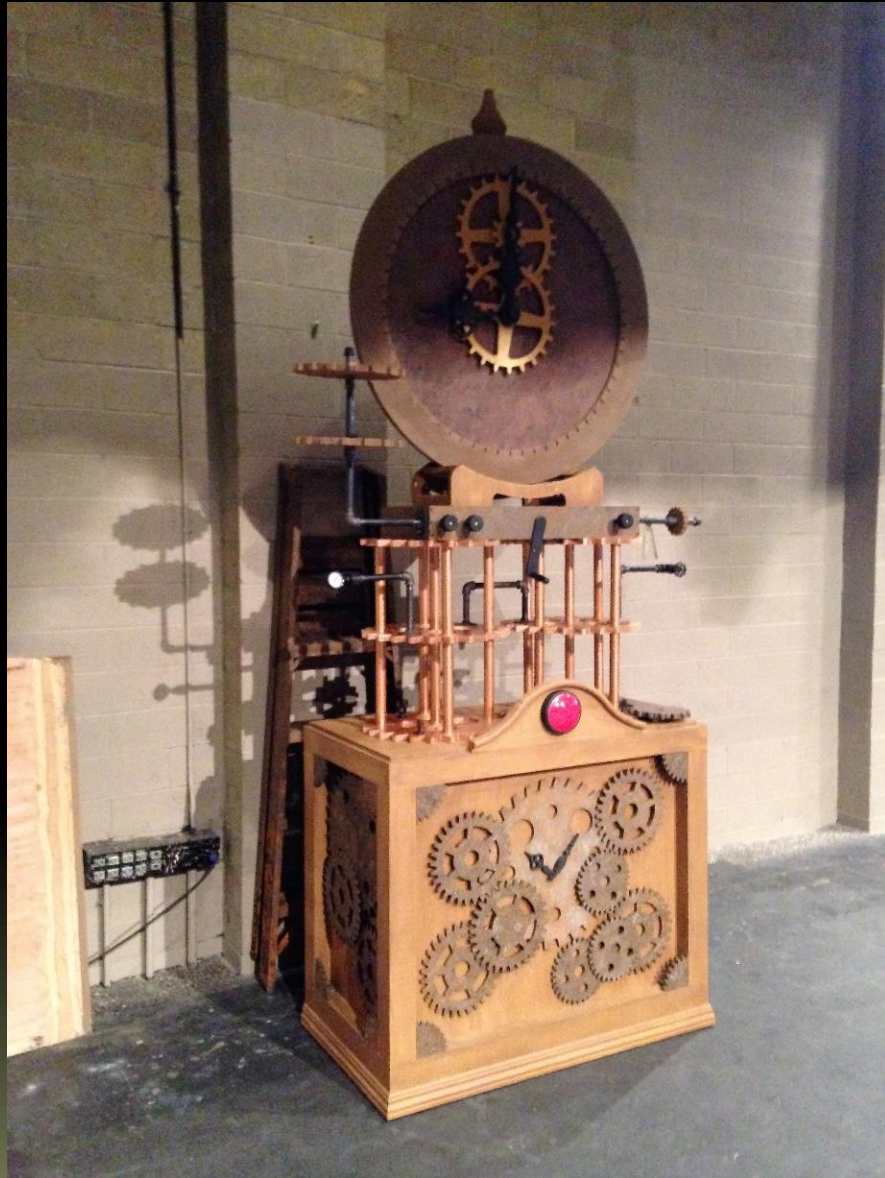

Scenery completed



Cast photo

California State University of Bakersfield-Lighting Designer & Master Electrician
Distinguished Young Woman of California 2018

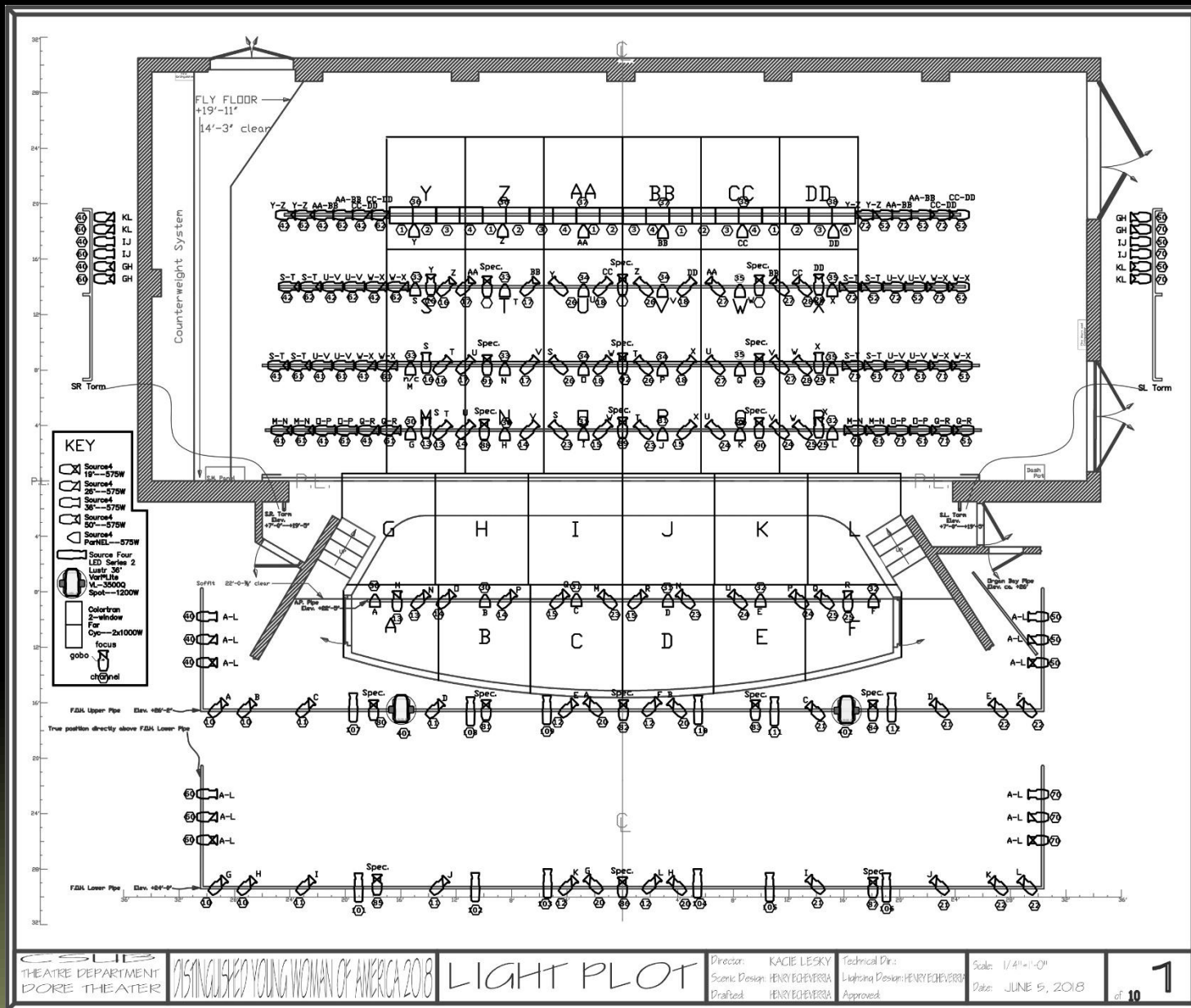



Production photos

California State University of Bakersfield-Technical Director
The Importance of Being Earnest



Scenic build in progress





The Importance of Being Earnest



Production photos

The Importance of Being Earnest

The Massachusetts Museum of Contemporary Art (MASS MoCA)
Scenic Designer & Technical Director
The Weeping Woman

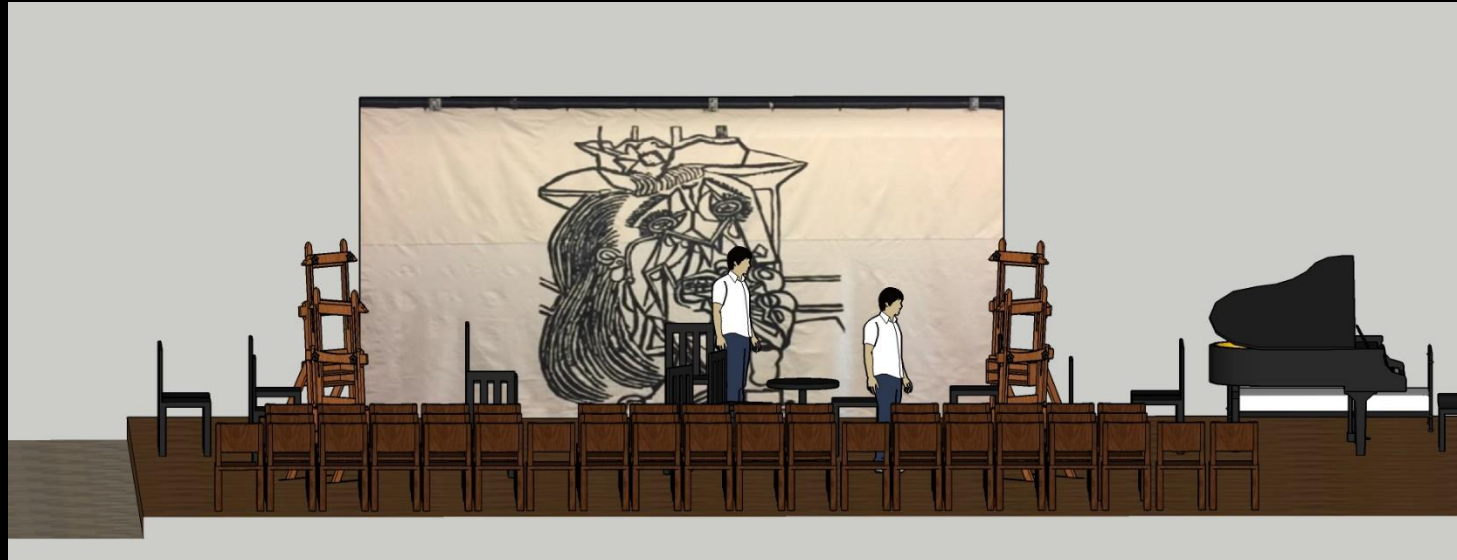

3D model rendering

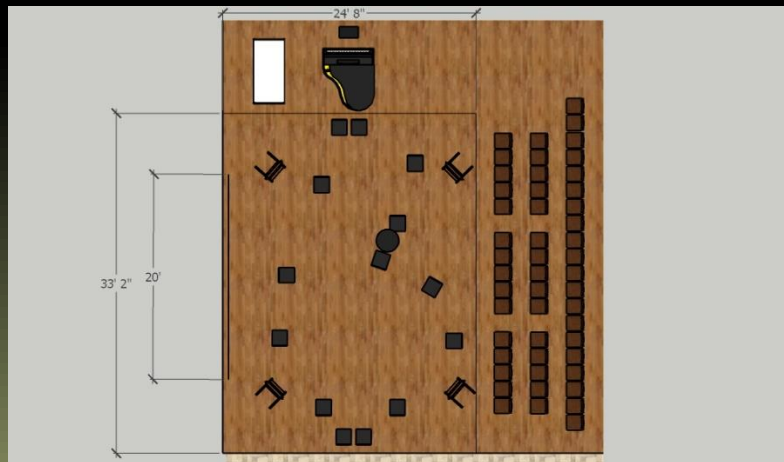

Ground plan





Production photos

Massachusetts College of Liberal Arts-Technical Director
Cloud 9



Production photos

La Boheme

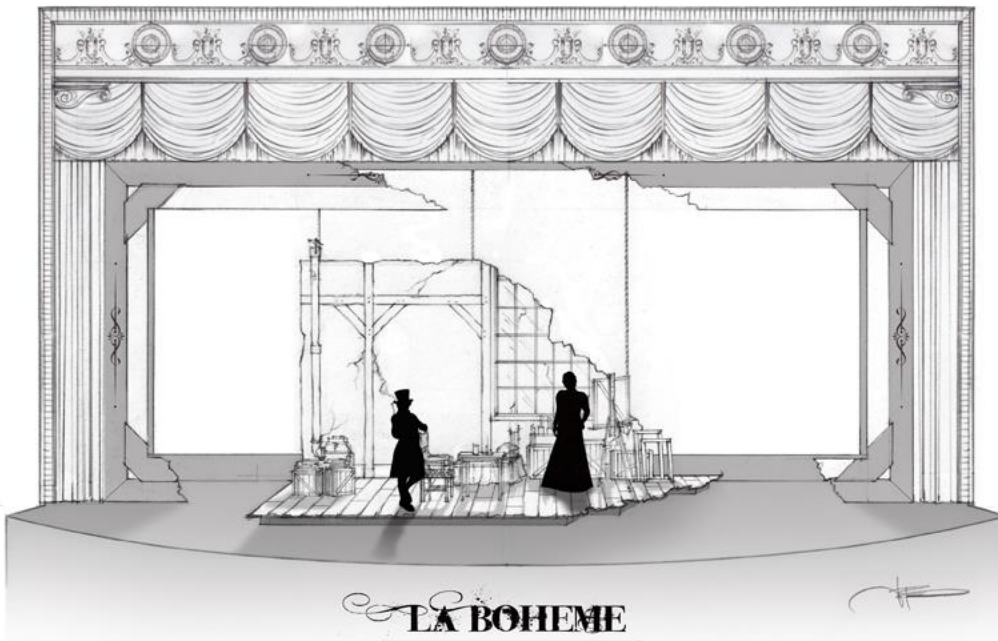

By Giacomo Puccini

ACT 1

PRODUCED BY ASH LAWN OPERA
PRESENTED AT THE PARAMOUNT THEATRE, CHARLOTTESVILLE VA
DIRECTED BY DAN RIGAZZI
SCENIC DESIGN BY JOHN POLLARD

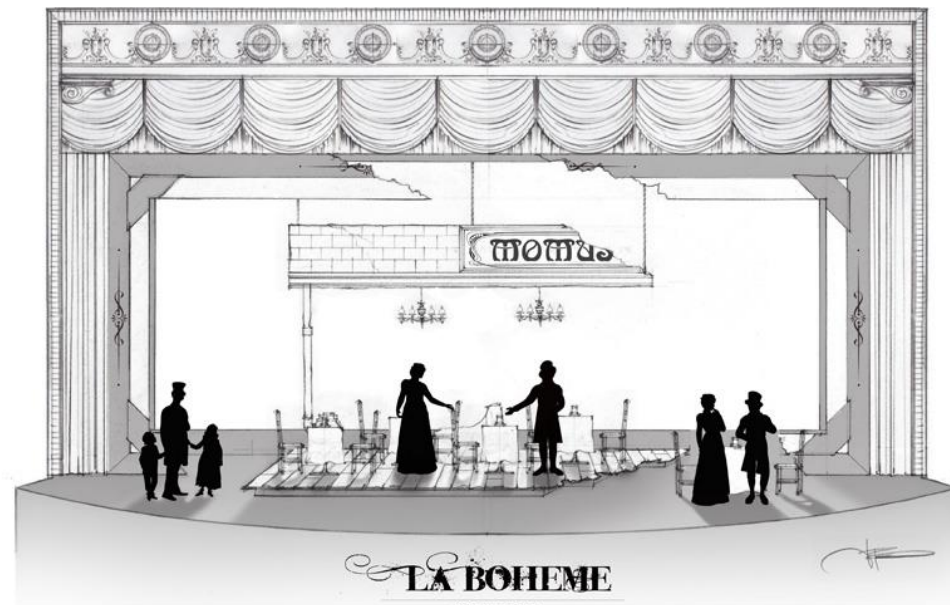

By Giacomo Puccini

ACT 2

PRODUCED BY ASH LAWN OPERA
PRESENTED AT THE PARAMOUNT THEATRE, CHARLOTTESVILLE VA
DIRECTED BY DAN RIGAZZI
SCENIC DESIGN BY JOHN POLLARD

Designer's Renderings

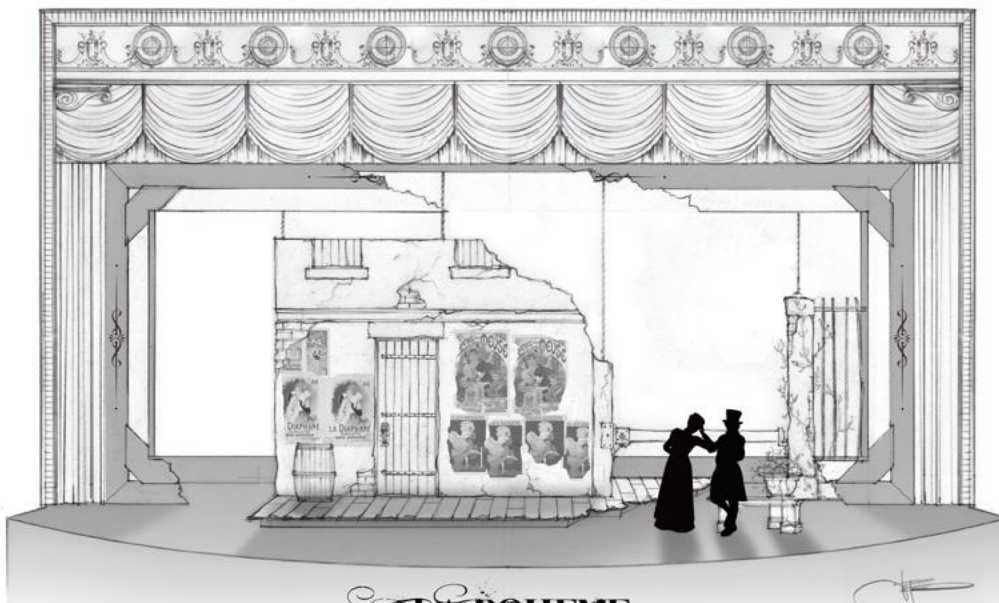

LA BOHEME

By Giacomo Puccini

ACT 3

PRODUCED BY ASH LAWN OPERA
PRESENTED AT THE PARAMOUNT THEATRE, CHARLOTTESVILLE VA
DIRECTED BY DAN RIGAZZI
SCENIC DESIGN BY JOHN POLLARD

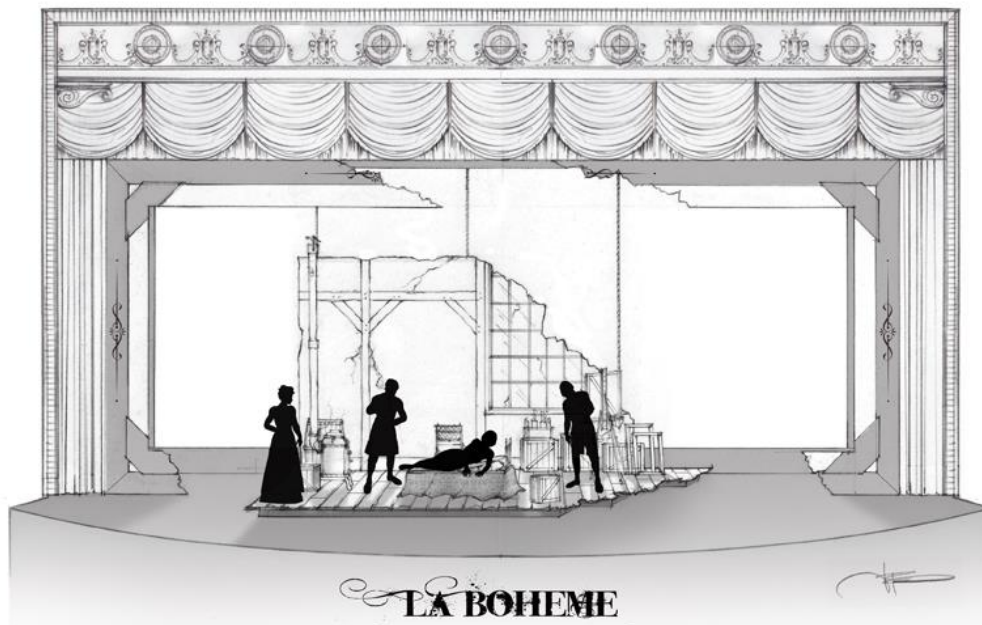

LA BOHEME

By Giacomo Puccini

ACT 4

PRODUCED BY ASH LAWN OPERA
PRESENTED AT THE PARAMOUNT THEATRE, CHARLOTTESVILLE VA
DIRECTED BY DAN RIGAZZI
SCENIC DESIGN BY JOHN POLLARD

Designer's Renderings

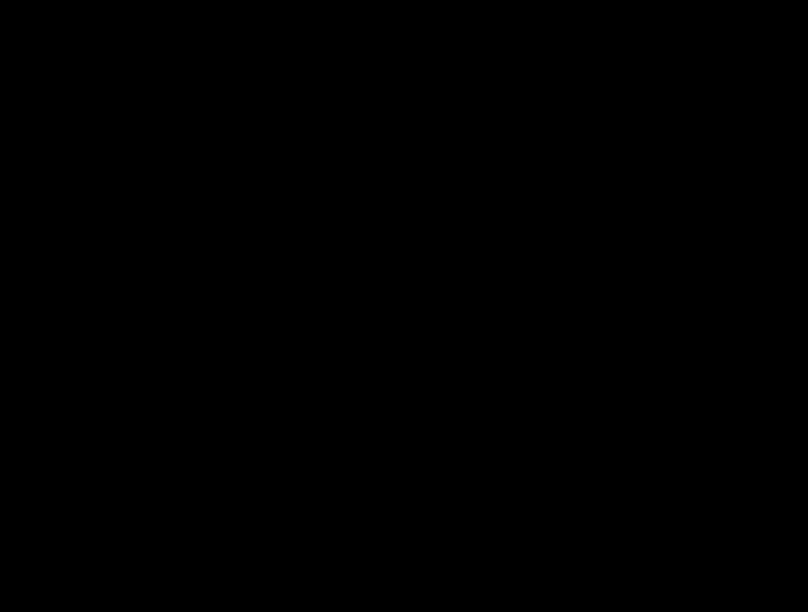

Shop (Horse Barn)



Shop (Horse Barn)



Floor in progress



Load in of floor



Production photo of floor



Carved foam example



Scenic prep in progress



Dry fitting walls



Close ups of wall



Production photo



Rear view of tavern wall



Welding broken window frame



Hanging wall



Steel attached to garret wall



Production photo



Cafe wall in progress



Cafe wall hung



Production photo

Carousel

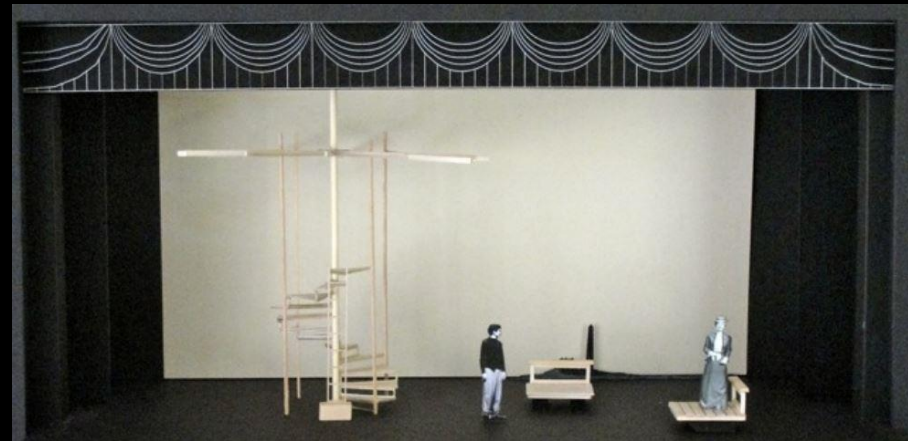
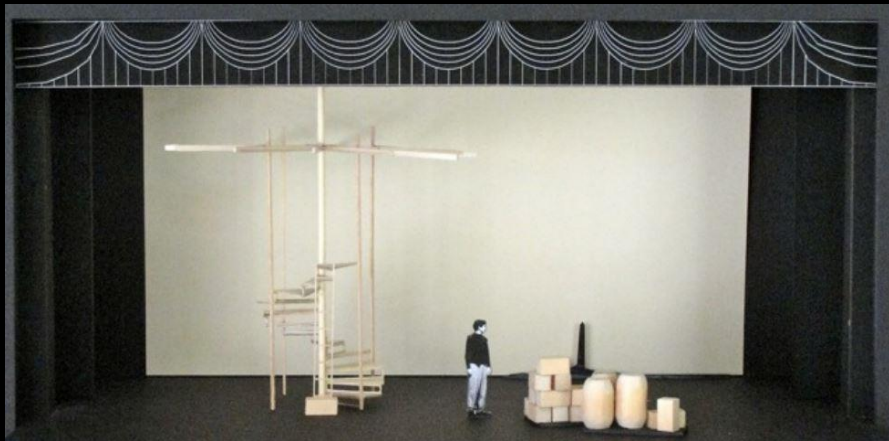

Designer's model

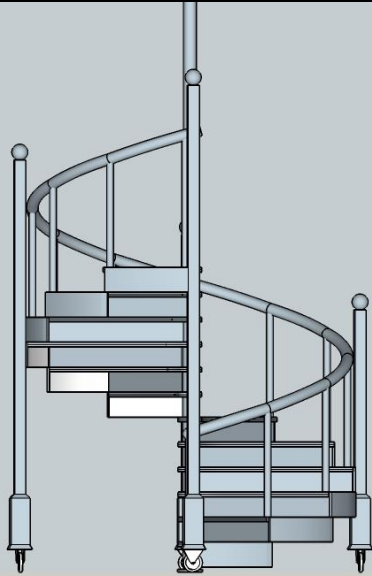

Initial model of spiral staircase

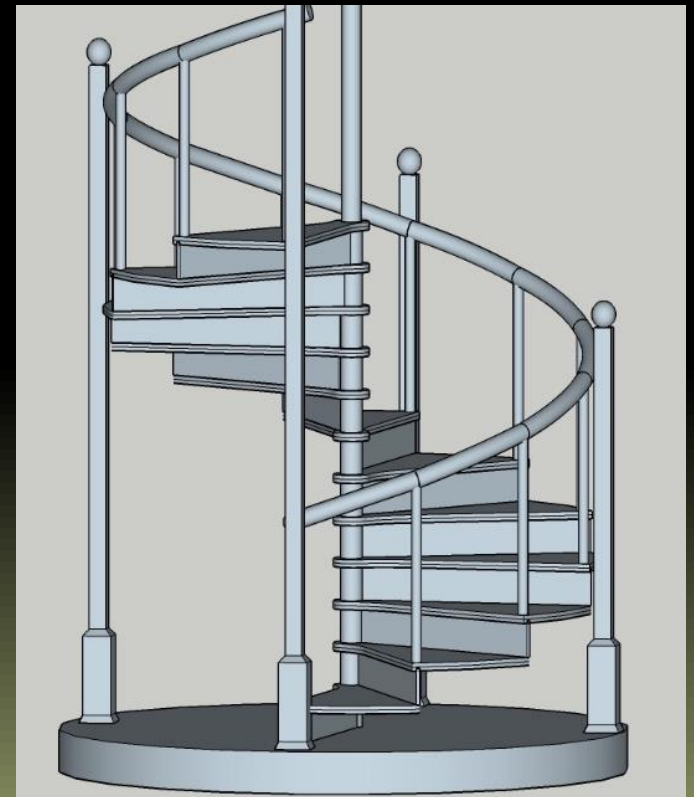
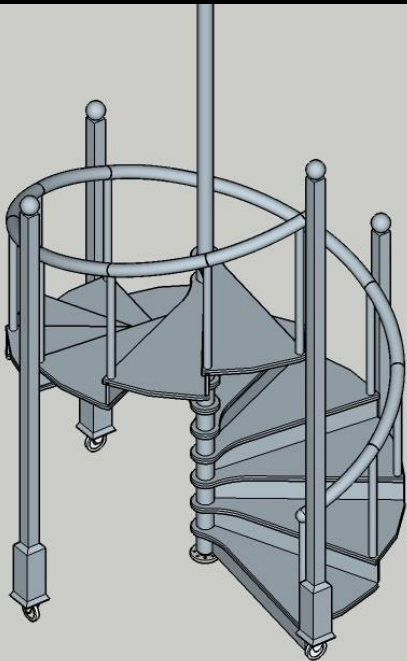

Edited model with revolve



Welding spiral stairs



Preliminary model



Pivot point welded



Revolve in progress





Loading in spiral stairs



Revolving spiral staircase



Star in progress



Star rigged and attached to show portal

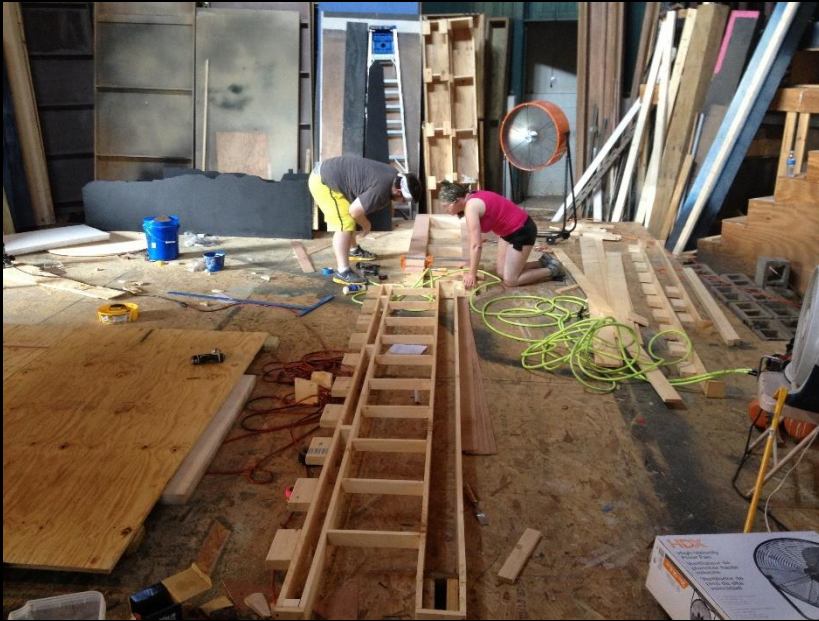

Show portal in progress





Wagon in progress



Horse mounted on wagon





Production photo